

Deeflexx

High-end sound-deflection system



Operating Manual *

* You can also download other language versions of this manual from the home page www.hoovi.at.

Important information

- Please carefully read the entire manual **BEFORE USE** to avoid hazards/injuries. Inappropriate use can result in injuries.
- Please keep this manual in a safe place and adhere to the safety and warning information contained in the manual.

Safety / Warning information

- Deeflexx is not a hearing protection device
- Please pay attention to sound levels, as high levels can lead to hearing damages or hearing loss!
- **CAREFUL!** Risk of cuts and injury at the edges and corners of the Deeflexx and additional diffuser. Carefully mount/dismount additional diffuser. Do not direct the Deeflexx/additional diffuser towards persons.

Deeflexx:

- Treat it like your guitar. Dropping the device or external force impact can lead to deformation and breakage. Do not re-use broken or defective components.
- No pressure may be exerted on the device during operation/transport; never stack more than two Deeflexx units on top of each other.

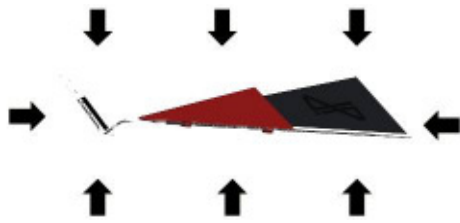

- Do not expose Deeflexx to heat sources that produce a lot of heat (heating units, stoves, floodlights, spotlights etc.).
- Minimum safety clearance of 2 metres for audience, do not use with crowds (risk of tripping)
- Adhere to your own safety clearance, including other musicians on stage (risk of tripping)
- Do not stack amplifiers/speakers on top of each other

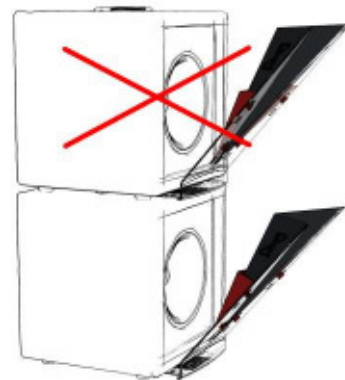
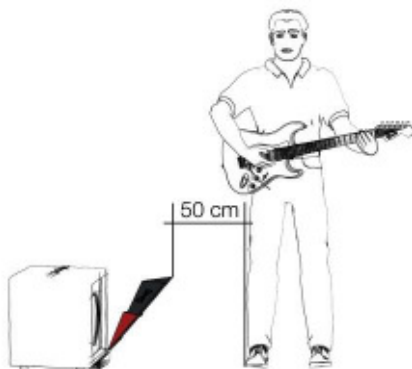

Delivery scope

- Deeflexx
- Additional diffuser

Note

- Lock additional diffuser into upper/first opening. Do not use lower/second opening, do not bend additional diffuser
- Materials used for the Deeflexx and the production process are subject to tolerances. This results in small variances, which are not considered production errors

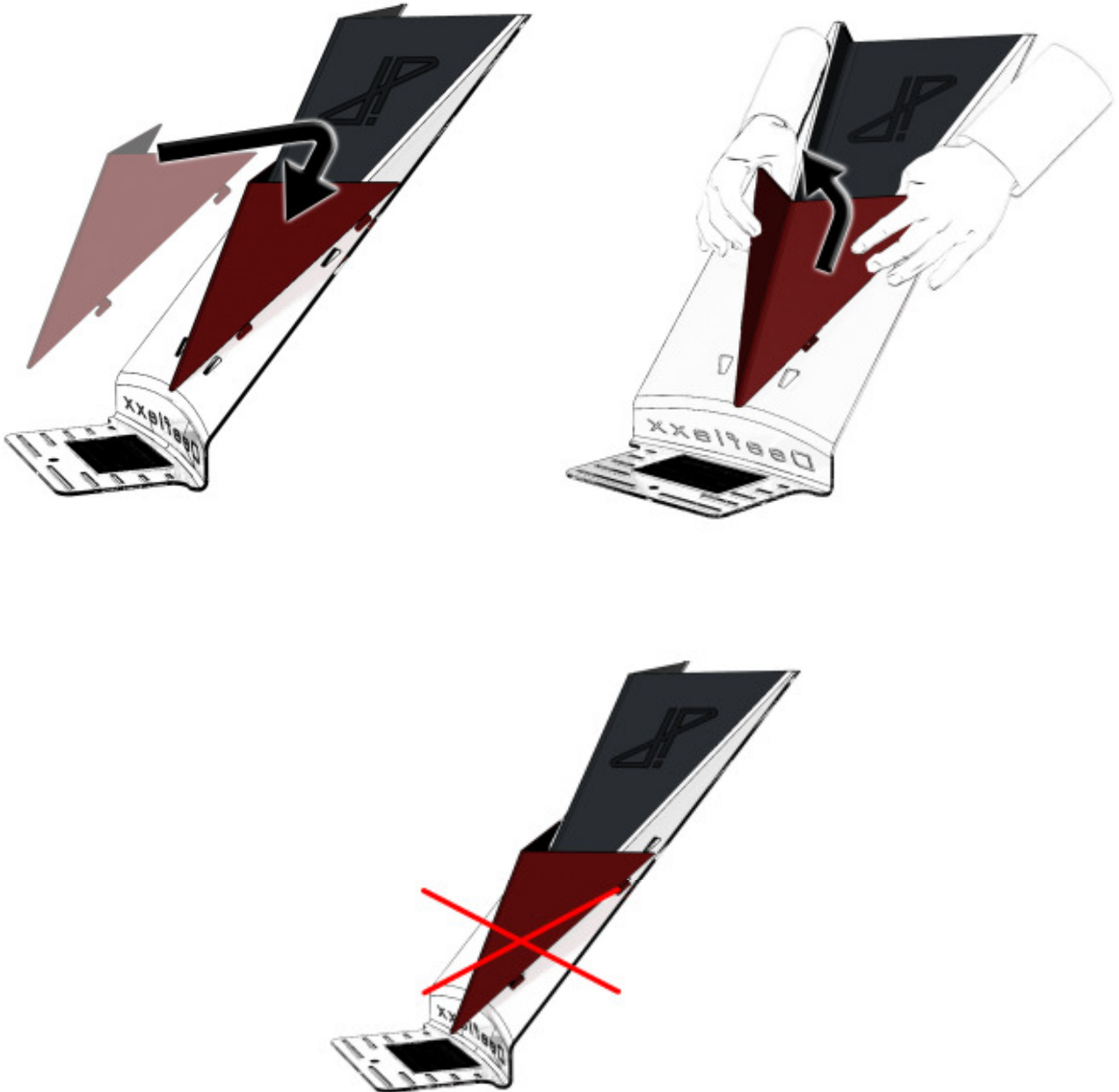

Highlights

- Absolutely NO BEAM
- Same sound for musicians and audience
- Sound radius 0.5 - 7 m, more than 180°
- Enhanced zones for musicians
- Very easy assembly - no installation required

Information for use

- Centring the Deeflexx
- Slightly tilt housing upward

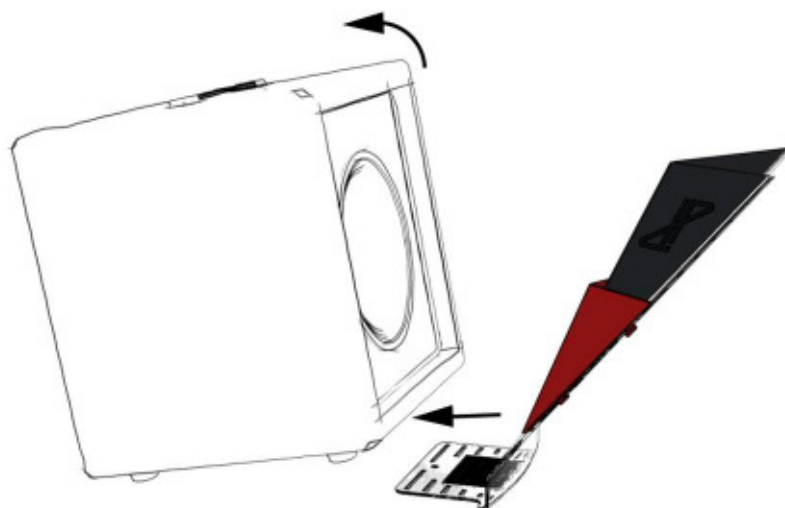
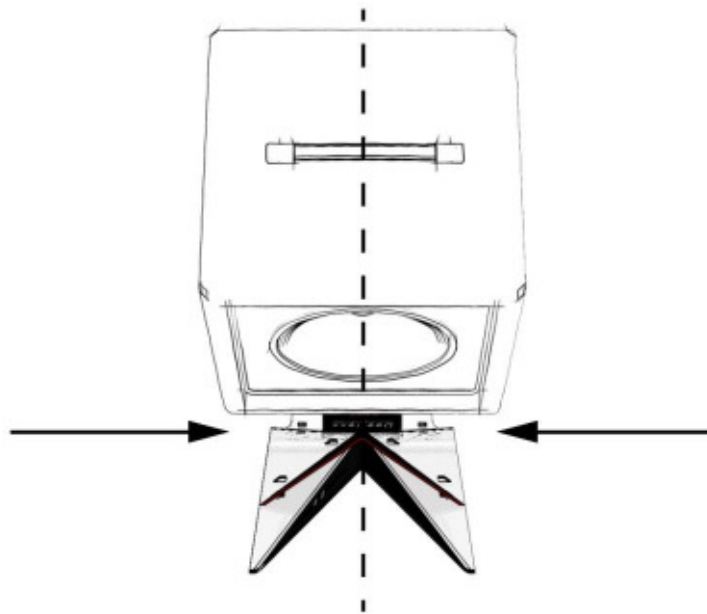

Comparison Beam - Deeflexx

BEAM

Deeflexx

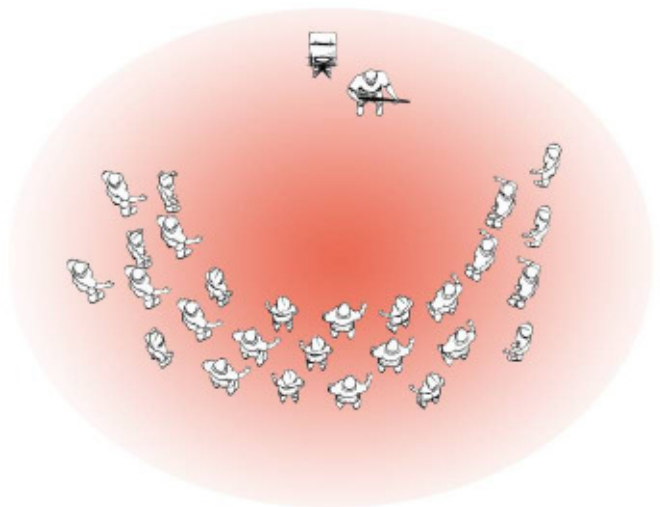
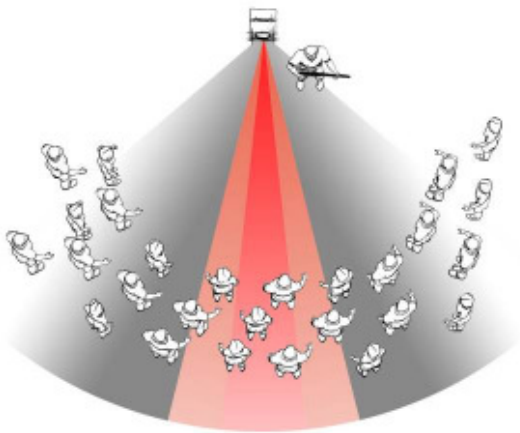
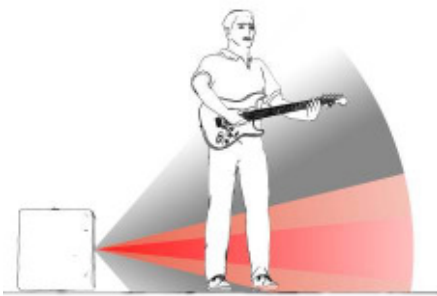
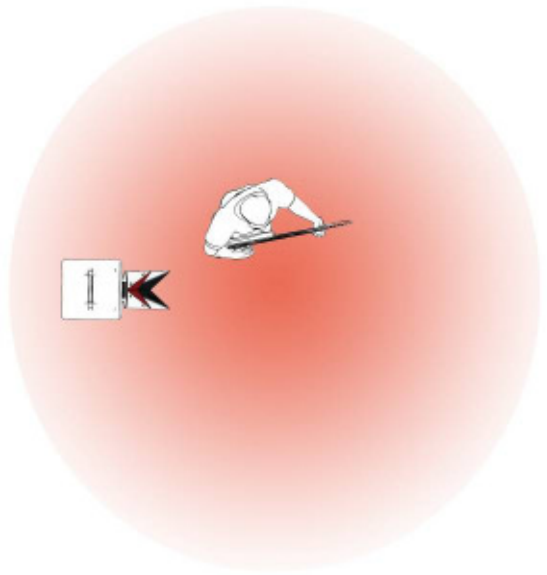
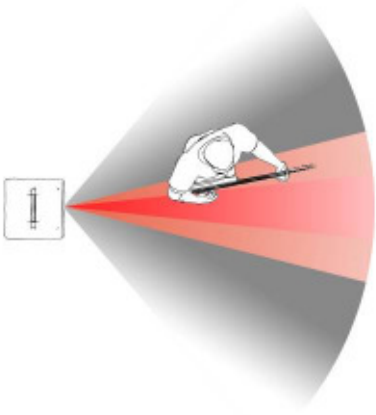

Enhanced zones

Deeflexx **without** additional diffuser



Deeflexx **with** additional diffuser

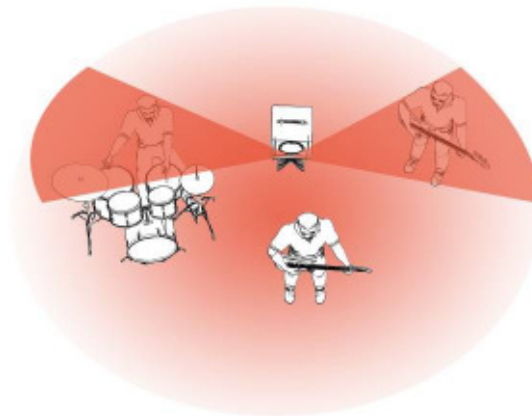

Microphone configuration

Live

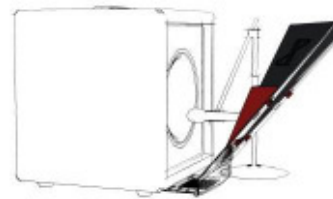

Studio

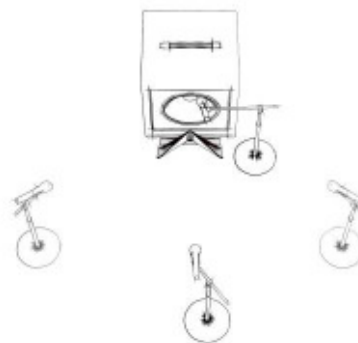

Speakers / Cabinets:

- 1 x 12" / 1 x 10" / 1 x 8" – Cabinet / Combo
- 2 x 12" Cabinet
- Max. speaker height: 50 cm
- Min. cabinet / amplifier weight: 2kg; otherwise add extra weight

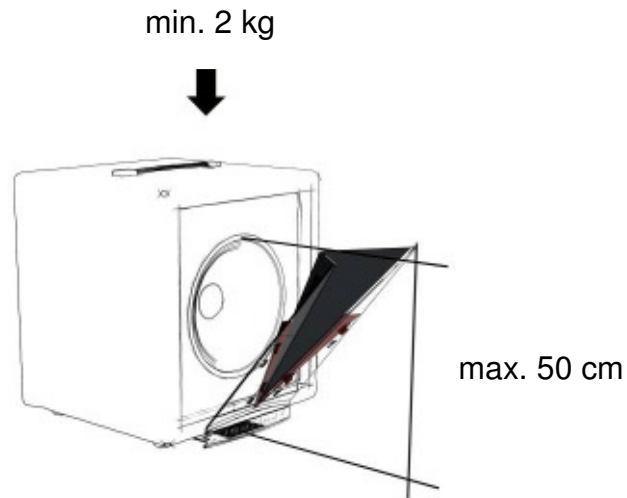

Transport - Storage

- The Deeflexx is stored/transported lying on its side (case) - remove additional diffuser if required
- Insert cloth/wrap between the devices, secure sides
- Storage temperature: -20°C - +40°C

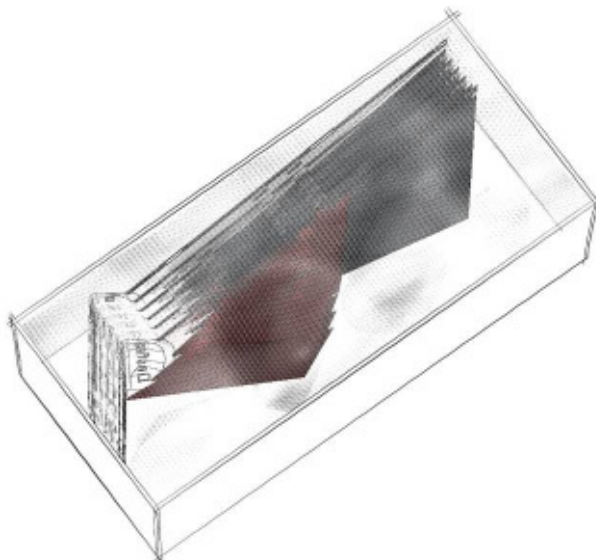

Cleaning / Maintenance

- Moist cloth (cotton), use small amounts of washing-up liquid for severe staining
- **DO NOT USE: alcohol/solvents, abrasive/corrosive materials**

Disposal

The Deeflexx and additional diffuser are not considered household waste. They must be disposed of at a municipal collection location or in accordance with the applicable local provisions.

Technical data

Type description	Deeflexx
Dimensions L x W x H (lying down)	approx. 650 x 280 x 120 mm
Height (standing)	approx. 450 mm
Weight	approx 1.3 kg
Temperature	-20°C - +40°C



Subject to technical changes without notice / Status February 2011 / © 2011 Hubert Hochleitner – HooVi

Fa. Hubert Hochleitner I Gallzeiner Weg 8 I 6130 Schwaz I Austria I www.hoovi.at I info@hoovi.at

□ You can also download other language versions of this manual from the home page www.hoovi.at.